

- NOTES:
- LAYOUT IS INDICATIVE ONLY. FINAL POSITION OF SERVICES TO BE CONFIRMED ON SITE.
  - ALL WASTEWATER WORKS TO BE IN ACCORDANCE WITH IRISH WATER WASTEWATER CODE OF PRACTICE.
  - ALL SURFACE WATER WORKS TO BE IN ACCORDANCE WITH GREATER DUBLIN REGIONAL CODE OF PRACTICE FOR DRAINAGE WORKS.
  - FOUL PIPE MATERIALS TO BE UPVC WAIN PIPE AS PER SECTION 3.13 IN THE IRISH WATER WASTEWATER CODE OF PRACTICE.
  - WHERE 1.2M COVER CANNOT BE ACHIEVED THE PIPE SHALL HAVE A CONCRETE SURROUND AS PER IRISH WATER WASTEWATER CODE OF PRACTICE MINIMUM COVER OF 750MM.
  - ALL PUMP CHAMBERS AND RISING MAINS TO BE DESIGNED BY SPECIALIST CONTRACTOR.
  - CARPARK DRAINAGE TO DISCHARGE INTO FOUL NETWORK VIA BYPASS INTERCEPTOR.
  - SLUNG FOUL DRAINAGE FROM CARPARK ROOF SLAB TO BE CONFIRMED BY M&E CONTRACTOR

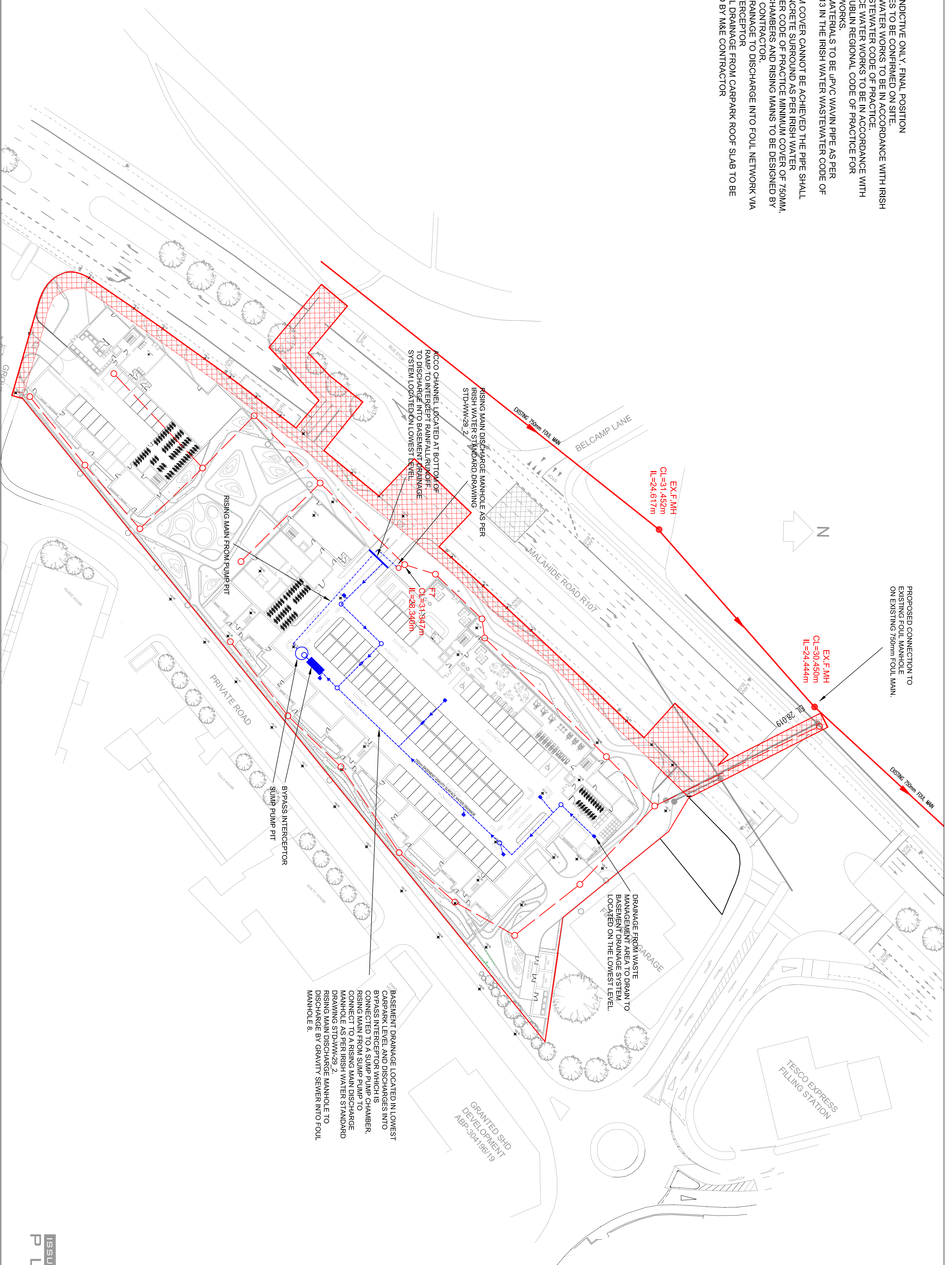

- NOTES:
- EXISTING FOUL MAIN
  - PROPOSED FOUL MAIN
  - EXISTING FOUL MANHOLE
  - PROPOSED FOUL MANHOLE
  - PROPOSED BASEMENT DRAINAGE
  - PROPOSED BASEMENT DRAINAGE GULLY
  - BYPASS INTERCEPTOR
  - PROPOSED SUMP PUMP PIT
  - PROPOSED RISING MAIN

REV	DATE	DETAILS
A	03/07/19	Issued for Pre SHD Application
B	11/11/19	Issued for SHD Application

**jor** Joseph O'Reilly  
 Consulting Civil & Structural Engineers  
 Unit 1, St. Therese's Place, Flowerhill, Navan, Co. Meath  
 Tel: 046 9077032 Fax: 046 9077932  
 Email: mail@jor.ie Web: www.jor.ie

CLIENT	Claregrove Developments Ltd
PROJECT	Residential SHD Development Clarehall, Malahide Road, Dublin
TITLE	Site Services: Basement drainage Layout
SCALE	A1 @ 1:500
DATE CREATED	May 2019
DRAWING No.	J19-002 004
REV	B

ISSUED FOR  
**PLANNING**